

1 2 3 4 5 6 7 8 9 10 11 12 13 14

A

Querschnitt
Cross section

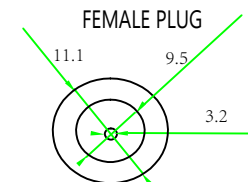
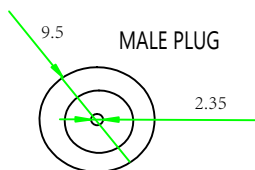
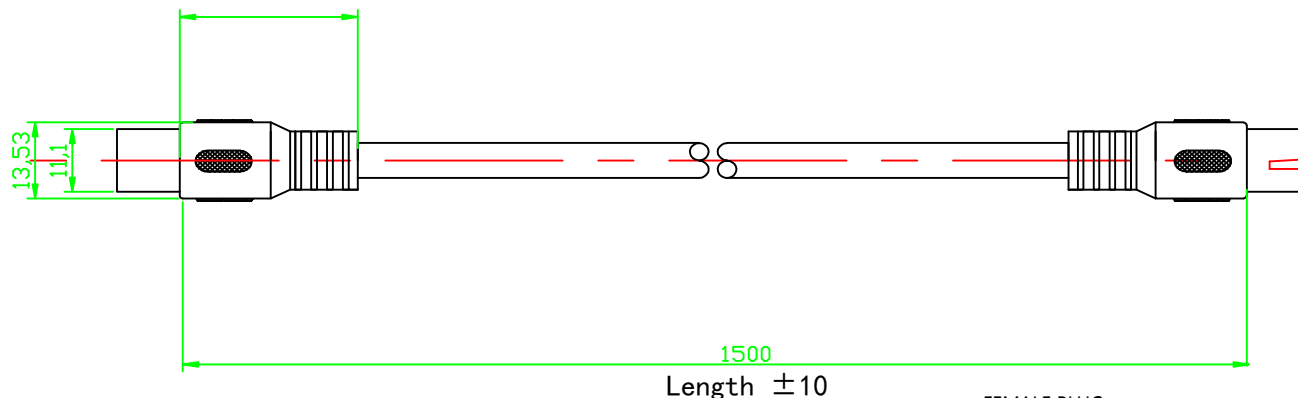
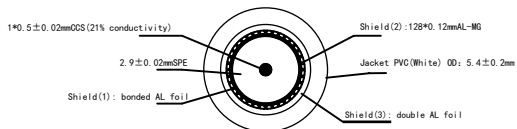

D

E

Schaltplan
Wiring diagram

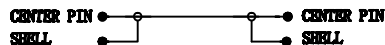

Elektrische Leistung:
Electrical Performance:

5-30 MHz T.I. <2.5
30-1000 MHz S.A >95 dB±10
5-1000 MHz R.L >15 dB
5-1000 MHz I.L <0.75 dB

Nr. / No.	Beschreibung / Description
58806	Class A+ Antenna cable IEC male/female 0100 1.0 m
58807	Class A+ Antenna cable IEC male/female 0150 1.5 m
58808	Class A+ Antenna cable IEC male/female 0200 2.0 m
58809	Class A+ Antenna cable IEC male/female 0300 3.0 m
58810	Class A+ Antenna cable IEC male/female 0500 5.0 m
58811	Class A+ Antenna cable IEC male/female 1000 10.0 m

Antennenkabel

- hochdichte 3-fach Abschirmung zur störungsfreien Signalübertragung
- voll abgeschirmter, beidseitig vergossener Koax-Stecker zum Schutz vor Staub, Schmutz und mechanischen Belastungen
- vernickelte, passgenaue Kontakte

- Anschlüsse: IEC-Stecker/ -Buchse (3C2V)
- SPE Dielektrikum
- CCS Innenleiter
- PVC Ummantelung
- 3-fach Schirmung: (AlMg Geflecht und 2-fach Al Folie)
- >95 dB Schirmungsmaß; Class A+

- Konformität: RoHS/REACH

Antenna cable

- triple shielded with high density for interference-free signal transmission
- fully shielded, encapsulated plug on both sides, protection against dust, dirt and mechanical loads
- nickel plated contacts

- Connections: IEC male/ female connector (3C2V)
- SPE dielectric
- CCS inner conductor
- PVC sheath
- 3-fold shielding: (AlMg mesh and 2-fold Al foil)
- >95 dB shielding measure; Class A+

- Conformity: RoHS / REACH

F

G

H

Änderungen

Datum	Name	gez.:	Datum	Name
		gez.:	24.09.2018	tf
		gepr.:	24.09.2018	tf
		Norm:		
Änderungen vorbehalten / Subject to change				

Bezeichnung
Class A+ Antenna cable
IEC male/female



Blatt

Zeichnungs-Nr.:

von

J

1 2 3 4 5 6 7 8 9 10 11 12 13 14